

Royal S 70F

Das gedämmte Falt-Schiebesystem mit geringen Ansichtsbreiten ist ideal eingesetzt, wo im geschlossenen Zustand perfekte Dichtheit und geöffnet hohe Transparenz gefordert ist.

The thermally insulated folding sliding system with narrow face widths is the ideal solution where there is a need for maximum weathertightness when closed and high transparency when open.

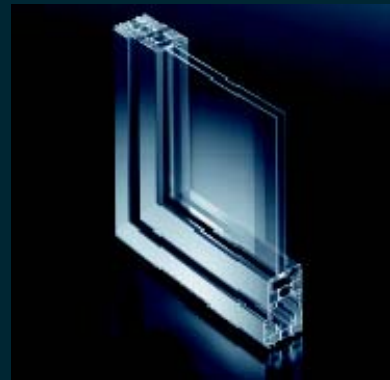

132 Eigenschaften und Vorteile
Features and benefits

134 Anwendungsmöglichkeiten
Possible applications

Royal S 70F

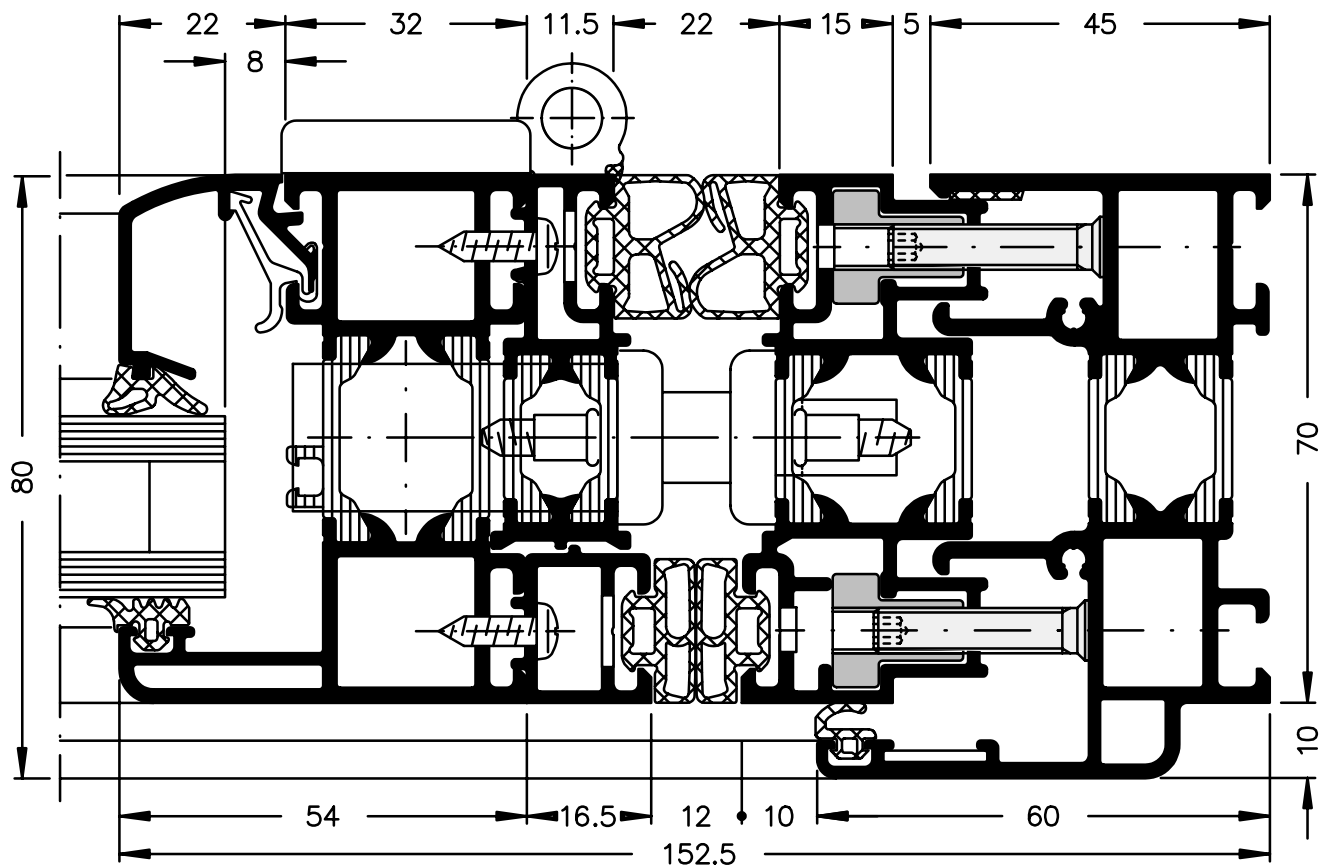
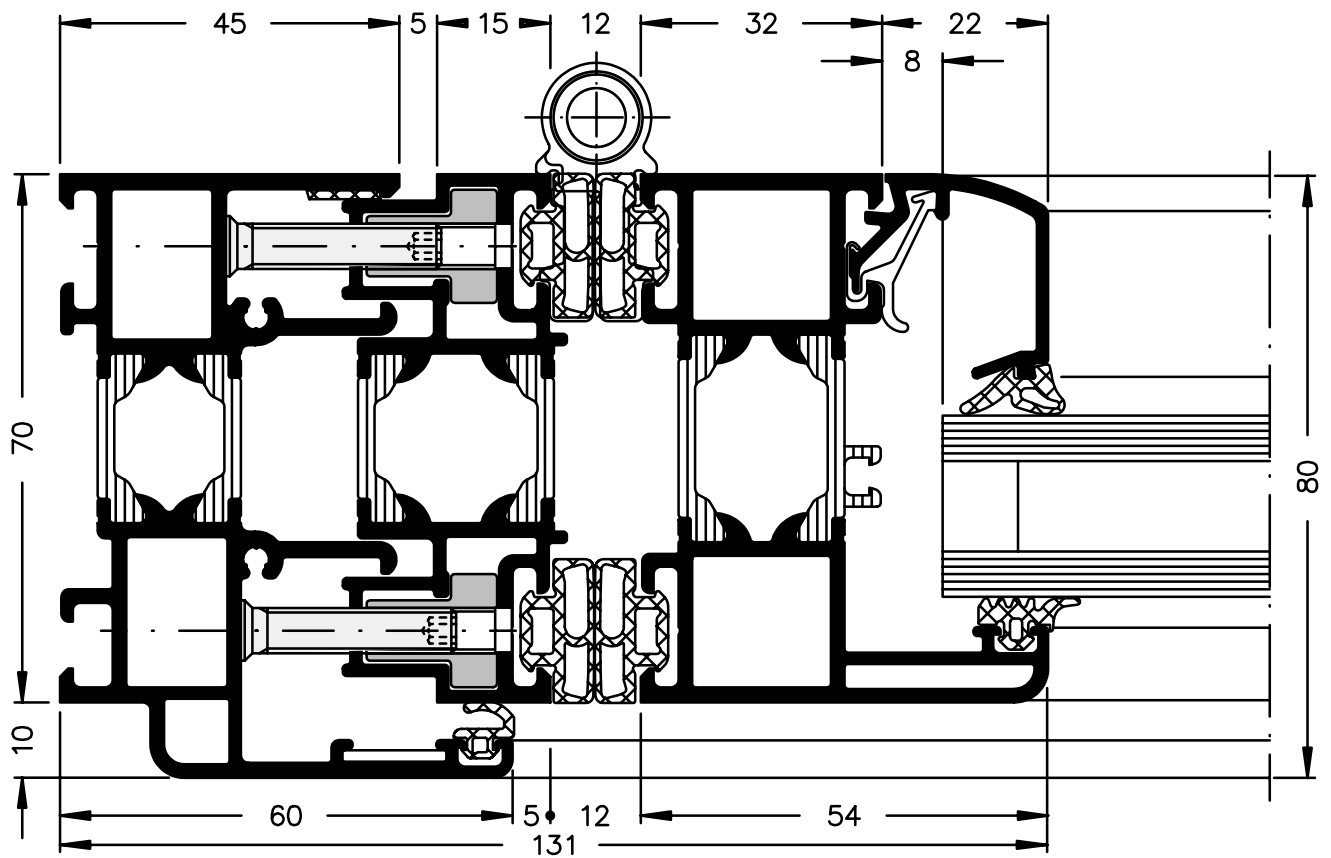

Maßstab 1:1

Scale 1:1

Eigenschaften und Vorteile

Features and benefits

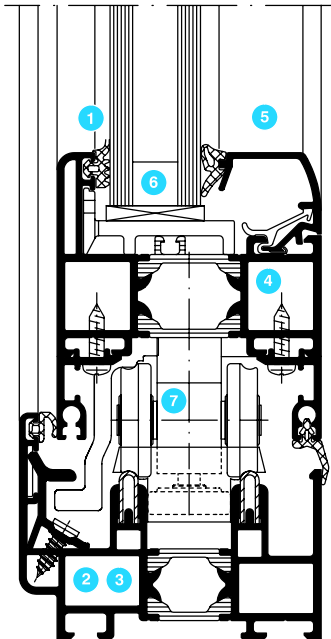

Optik

- Faltschiebesystem mit schmalen Ansichtsbreiten ab 60 mm, geringer Rahmenanteil, hoher Scheibenanteil
- formschönes Design durch abgerundete Profilkanten
- 1 ● Glasdichtungen aus EPDM mit minimal sichtbaren Dichtlippen verhindern "Trauerränder"
- flächenbündige Glasleiste
- Blend- und Flügelrahmen werden umlaufend auf Gehrung gearbeitet

Wasserführung

- 2 ● Entwässerung an der tiefsten Profilstelle und große Vorkammer ergeben hohe Schlagregensicherheit
- 3 ● auch verdeckt liegende Entwässerung möglich

Funktionalität

- 4 ● glatte Dreikammerprofile sind stabil und leicht zu verbinden
- große Farbvielfalt möglich, auch außen andersfarbig als innen
- einbruchhemmend Klasse WK 2 gemäß DIN EN V 1627, je nach Ausführung
- geeignet für den Einsatz in Wohn- und öffentlichen Bereichen
- schlagregendicht, je nach Ausführung, bis Klasse 9A DIN EN 12208
- 5 ● Einbauhöhe bis 100 m
- 6 ● Glasstärken von 6 - 45 mm einsetzbar
- Schalldämmung bis Schallschutzklasse 4 möglich
- 7 ● leichter und geräuscharmer Lauf der Faltelemente
- wahlweise flache Bodenschwelle z.B. für Geschäftszentren

Design

- Folding sliding system with narrow face widths from 60 mm, proportionally narrow frames to large panes
- Attractive design with radiused profile edges
- 1 ● EPDM glazing gaskets with discreet gasket lips prevent black borders
- Flush-fitted glazing bead
- Outer and vent frames are mitre cut on all corners

Drainage

- 2 ● Drainage at the lowest point of the profile and large front chambers ensure the best resistance to driving rain
- 3 ● Concealed drainage is also possible

Functions

- 4 ● Smooth 3-chamber profiles are robust and easy to join
- Wide choice of colours, different colours inside and outside
- Burglar resistance class WK 2 in accordance with DIN EN V 1627, dependent on design
- Suitable for use on public and residential property
- Weathertightness up to class 9A in accordance with DIN EN 12208, dependent on design
- 5 ● Installation height up to 100 m
- 6 ● Glazing thicknesses of 6 - 45 mm can be used
- Sound insulation up to sound insulation class 4 possible
- 7 ● Folding units move smoothly and quietly
- Option of flush threshold profile, e.g. for business centres

Anwendungsmöglichkeiten

Possible applications

Ausführung - nach innen öffnend
Inward opening design

Typ 3
Type 3

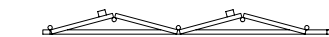
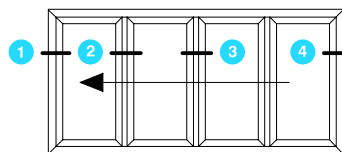

ca. 325
Approx. 325

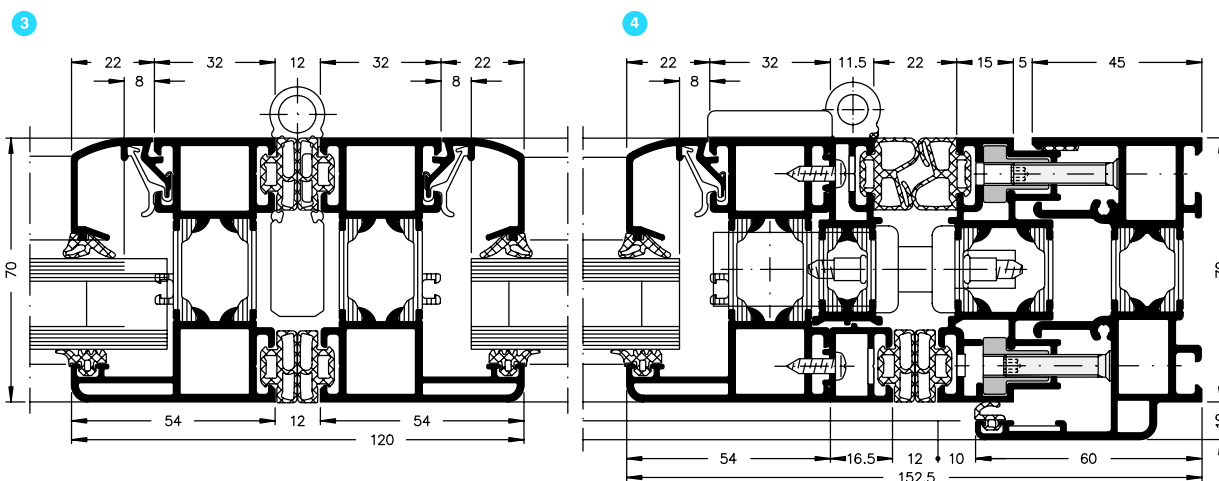
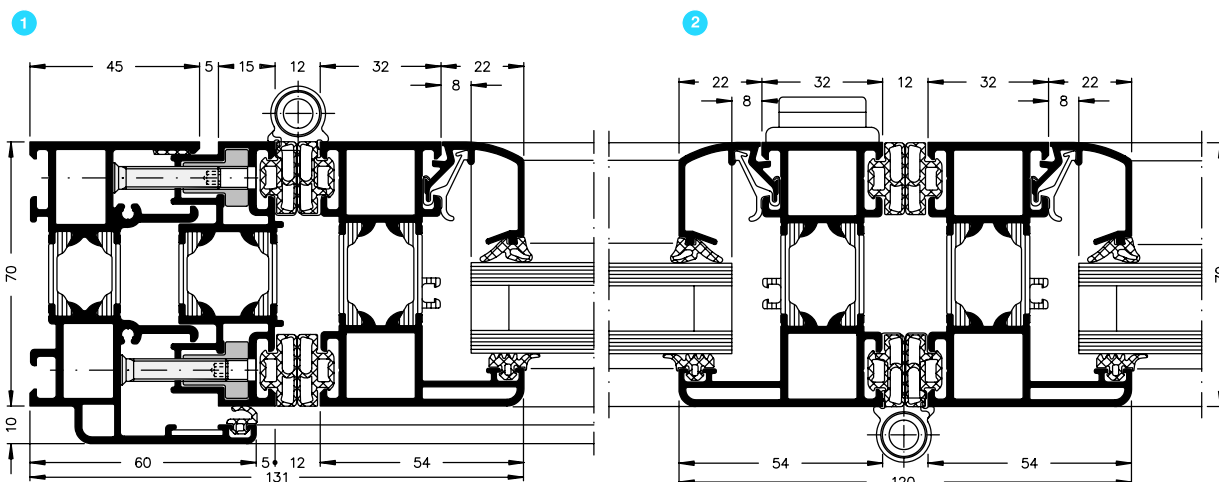

Maßstab 1:2
Scale 1:2

Typ 3.1
Type 3.1

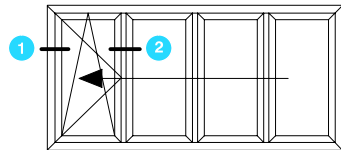

1

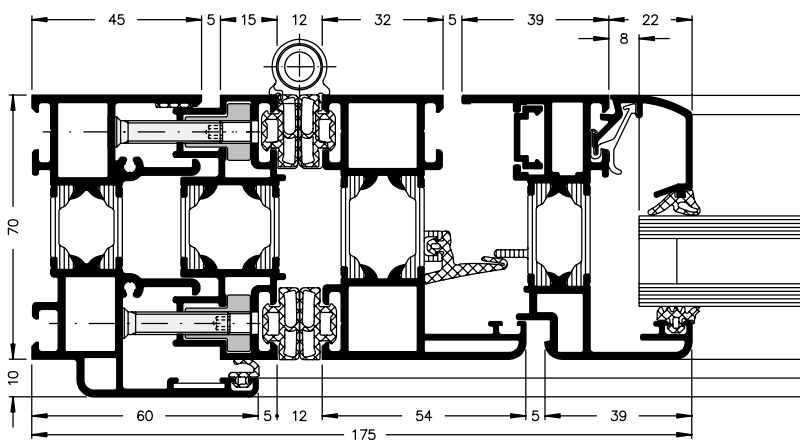

2

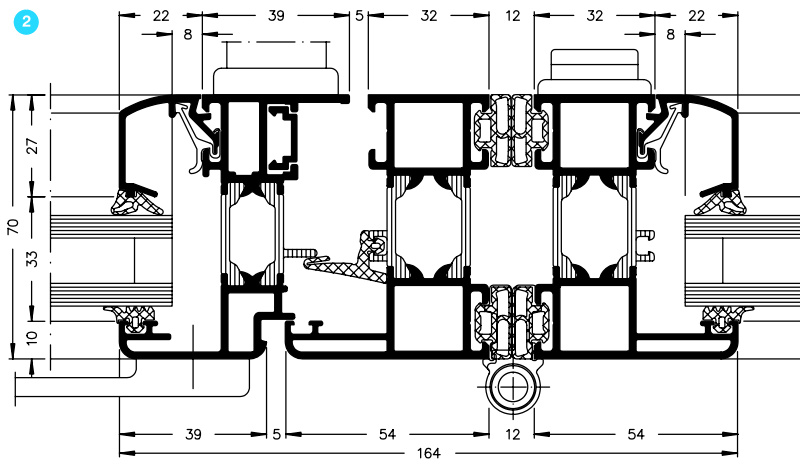

Maßstab 1:2
Scale 1:2

Ausführung - nach innen öffnend
Inward opening design

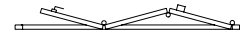
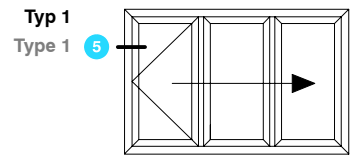

ca. 320
Approx. 320

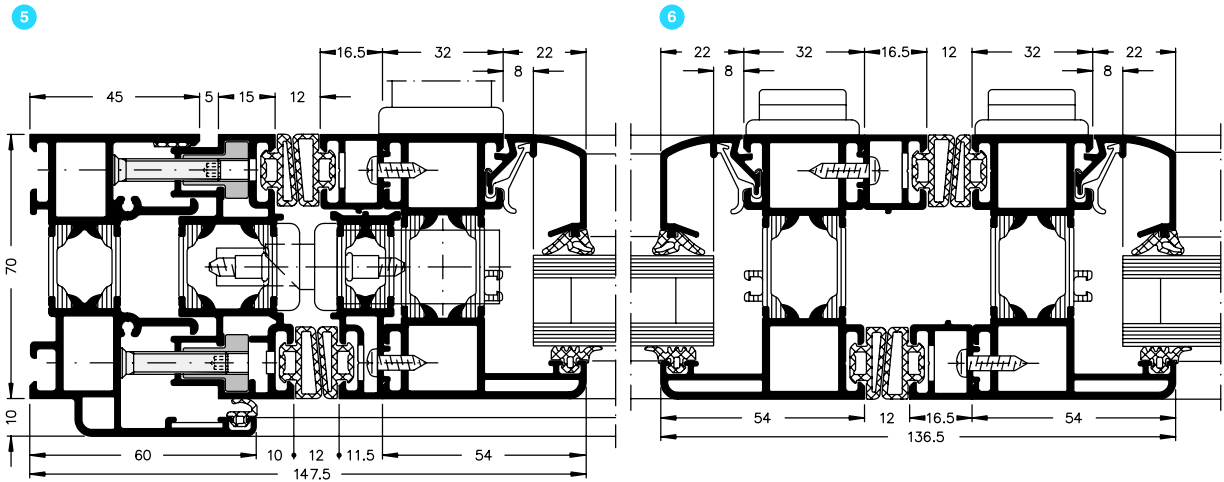

Typ 6
Type 6

6

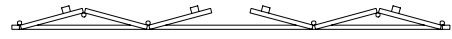
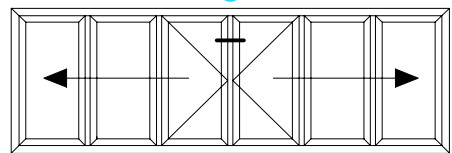

ca. 240
Approx. 240

ca. 240
Approx. 240

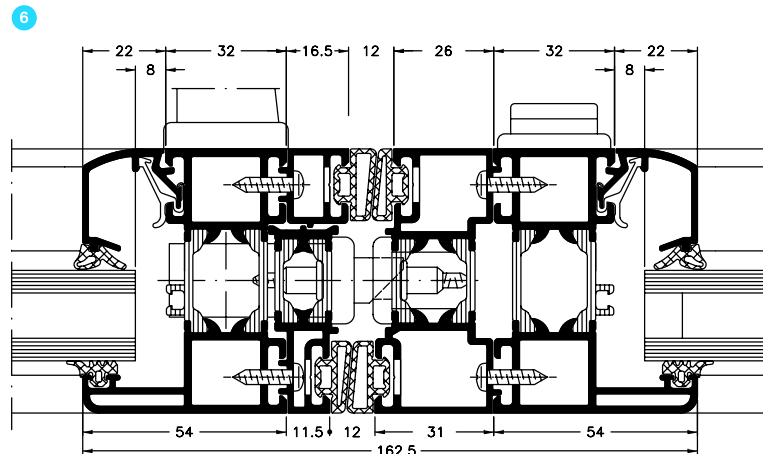

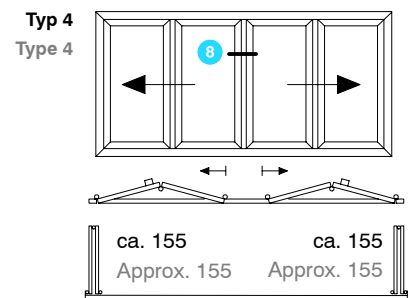
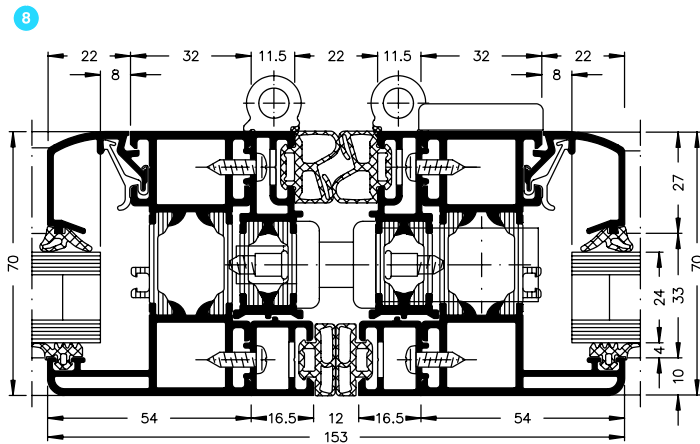
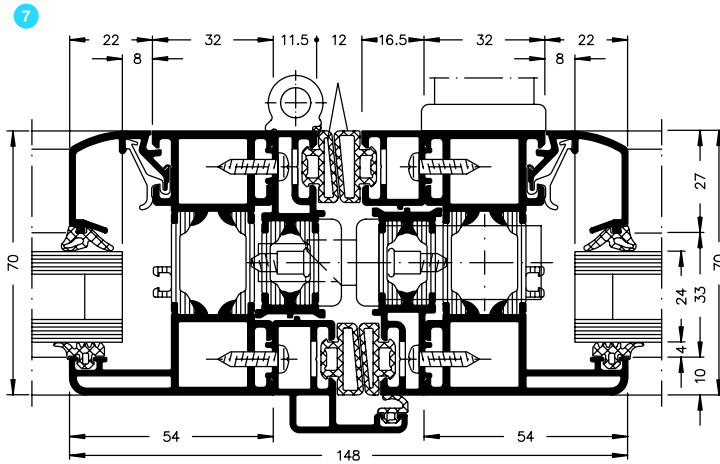
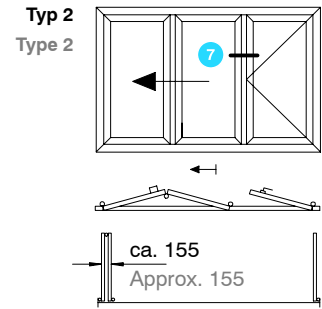
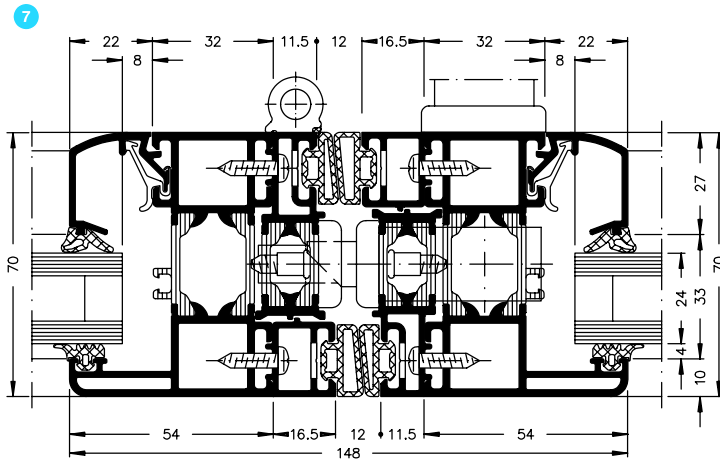

Maßstab 1:2
Scale 1:2

Oberer und unterer Türabschluss
nach innen öffnend
Top and bottom door sills
inward opening

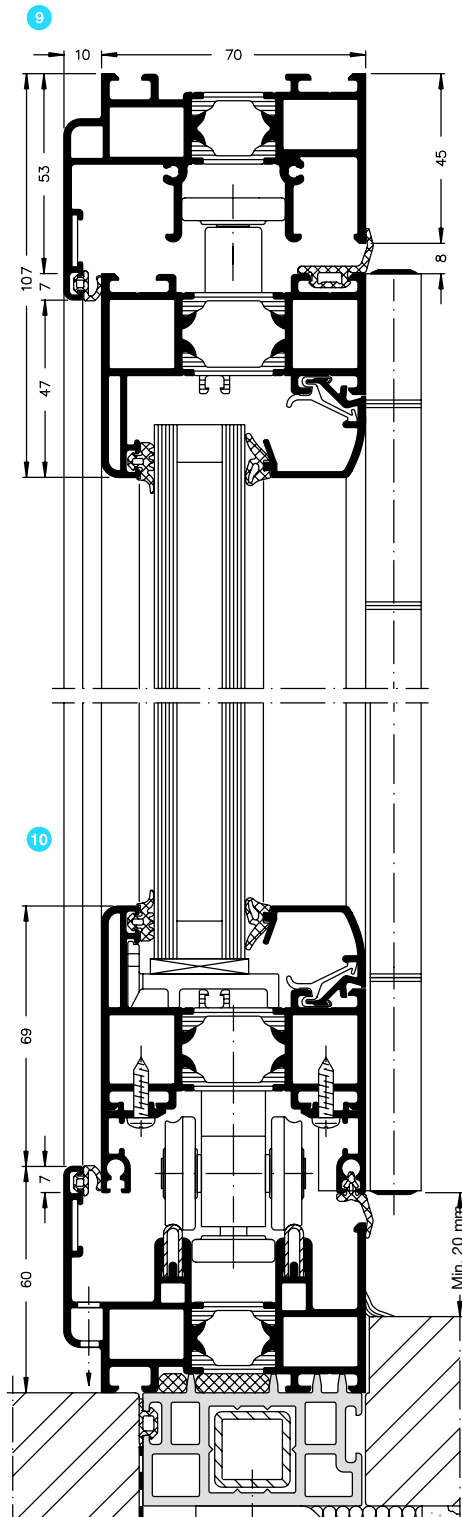

Maßstab 1:2
Scale 1:2

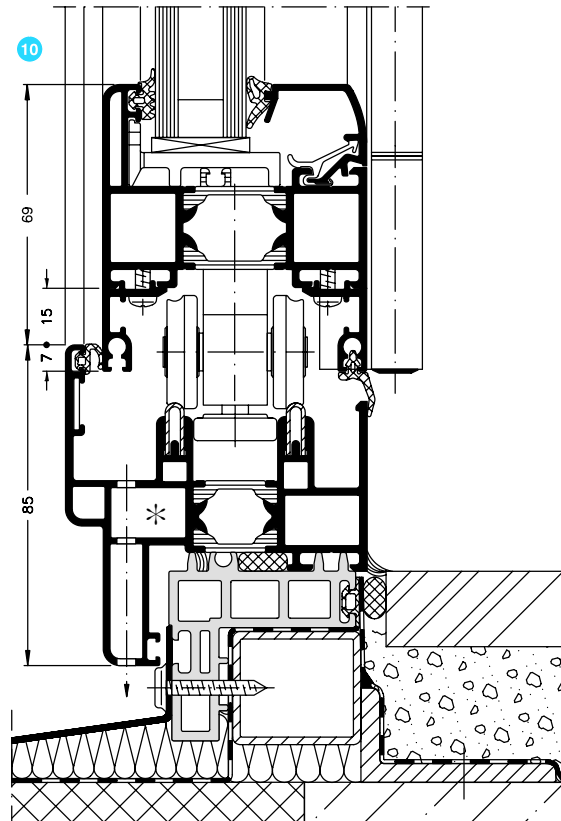
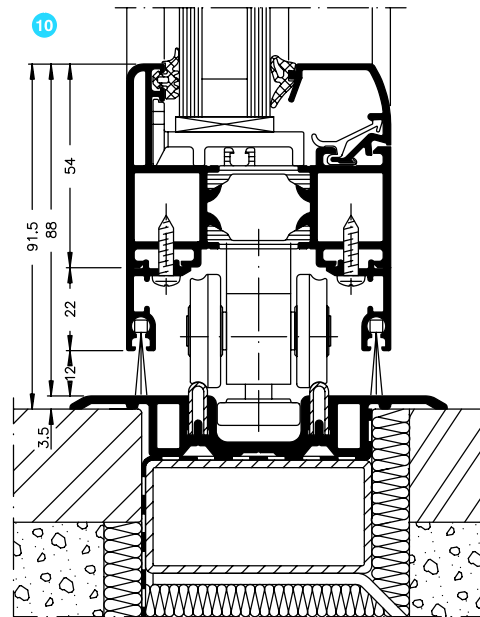
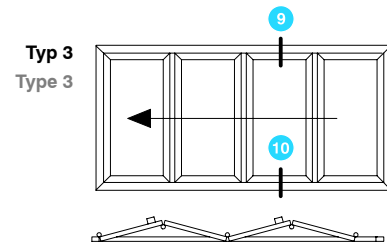

* Blendrahmen für erhöhte Schlagregendichtheit
Outer frame for increased weathertightness

Oberer und unterer Türabschluss
 nach innen oder nach außen öffnend (nicht gezeichnet)
 Ausführung Sicherheitsklasse WK 2
 Top and bottom door sills
 inward opening or outward opening (not shown)
 security class WK 2

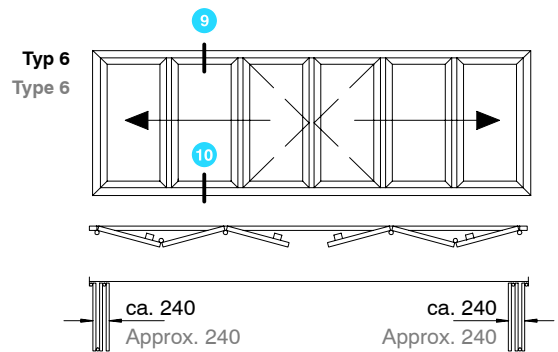
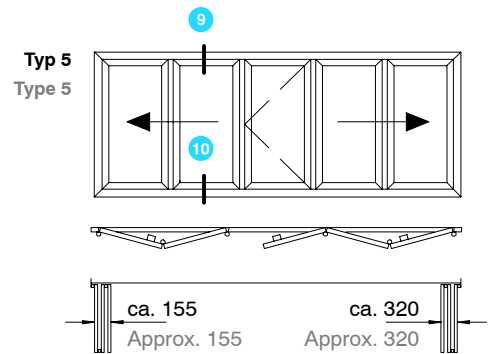
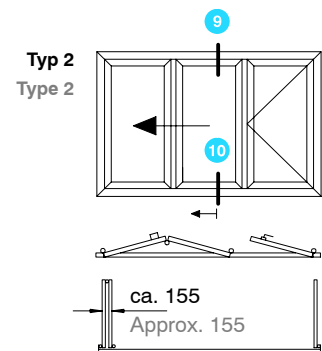
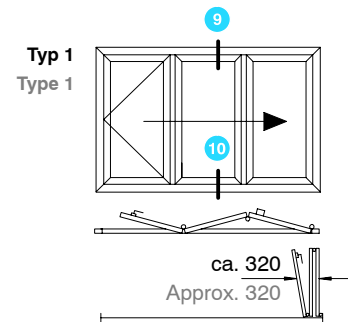
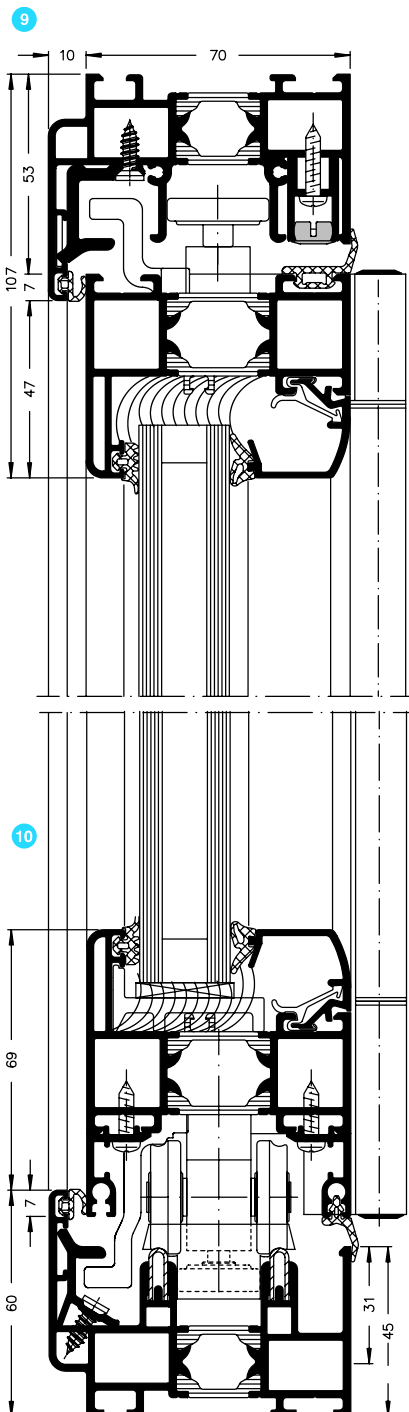

Ausführung - nach außen öffnend
Outward opening design

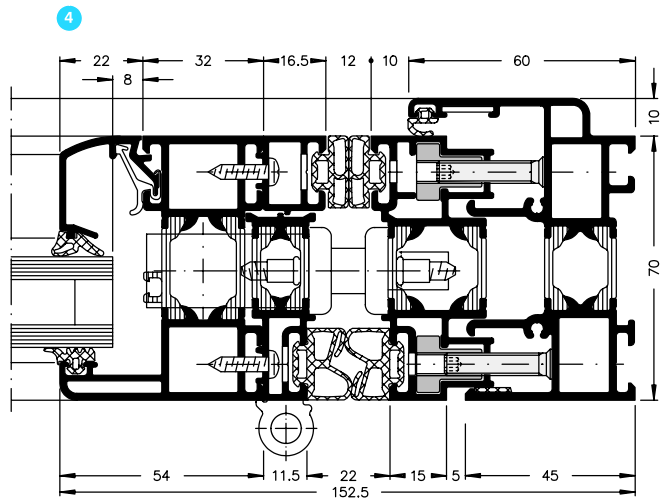
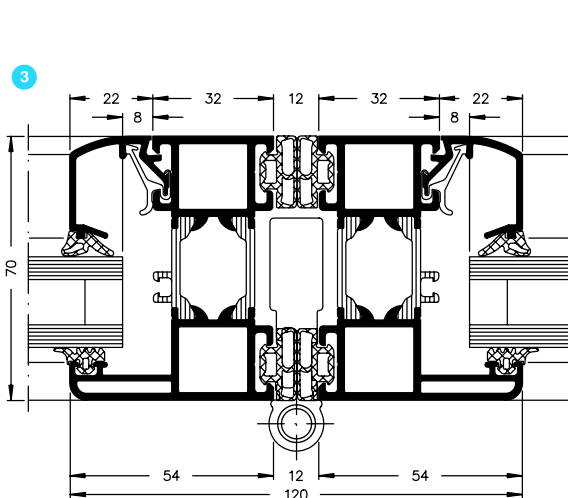
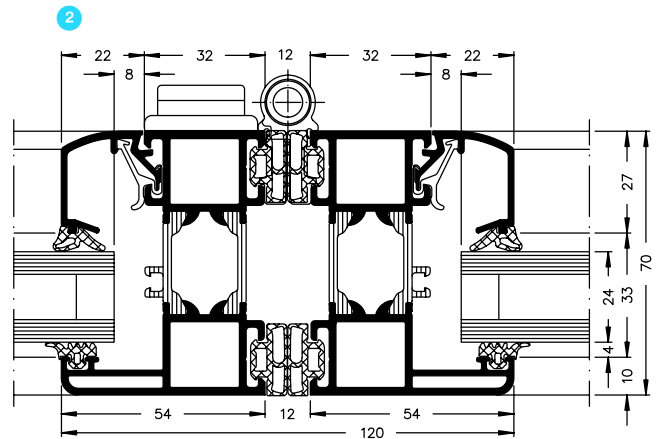
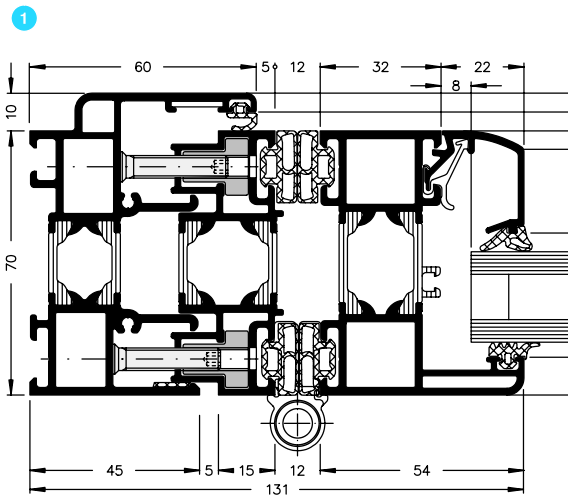
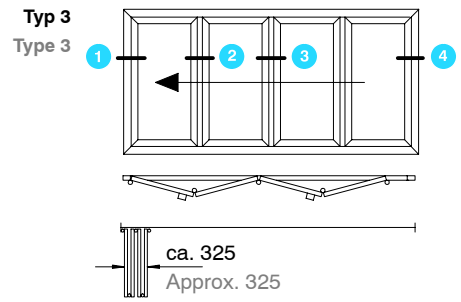

Maßstab 1:2
Scale 1:2

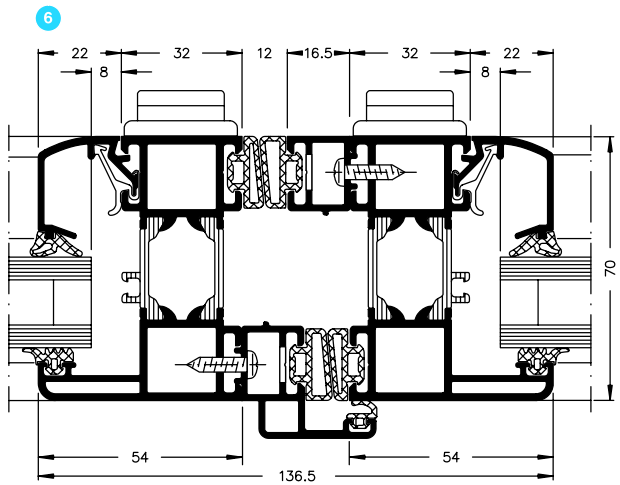
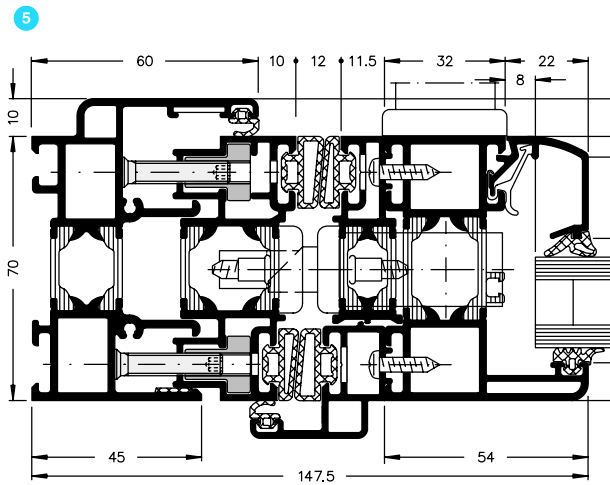
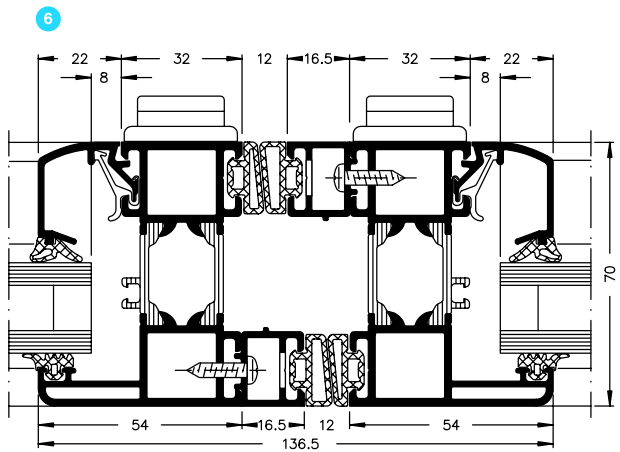
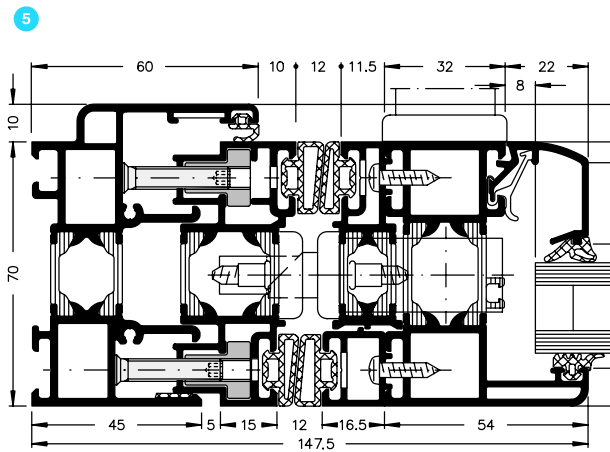
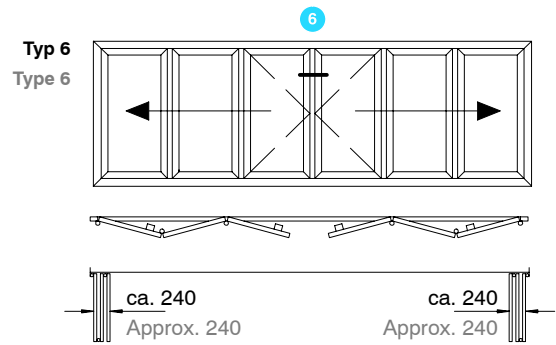
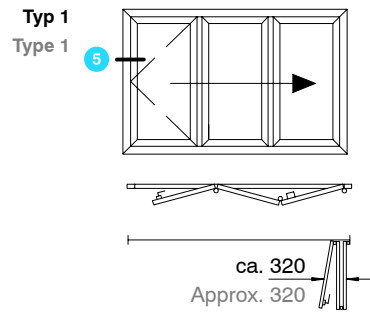

Maßstab 1:2
Scale 1:2

Ausführung flache Bodenschwelle
nach außen öffnend
Flush threshold profile
outward opening

Typ 6
Type 6

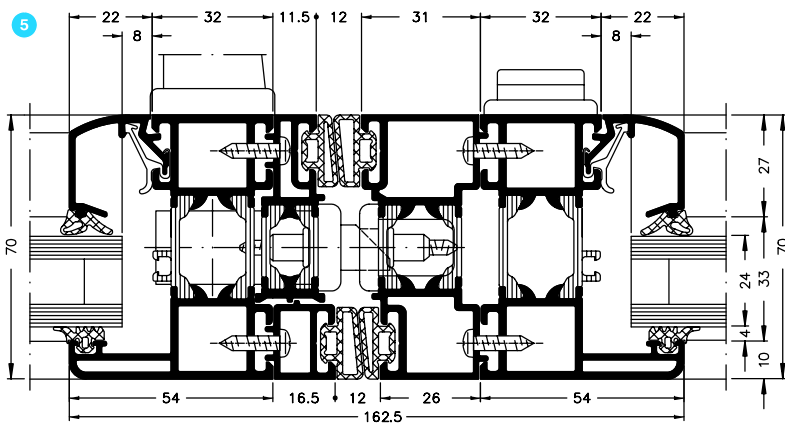
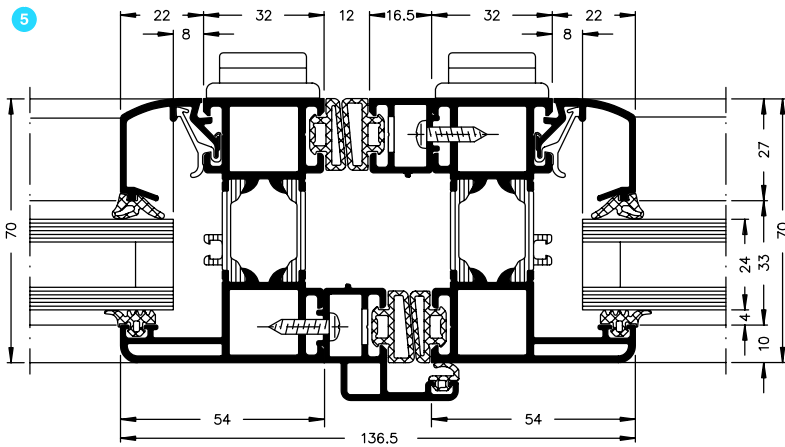
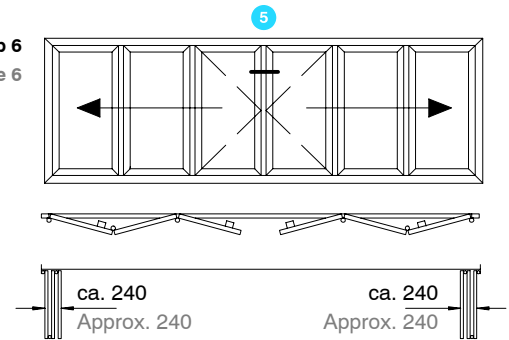

Oberer und unterer Türabschluss
nach außen öffnend
Top and bottom door sills
outward opening

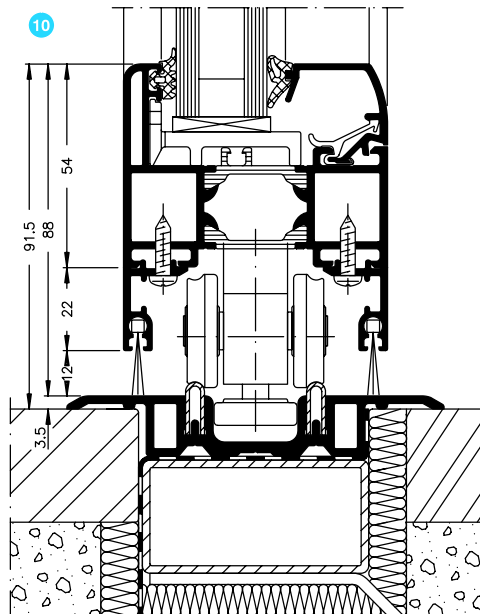
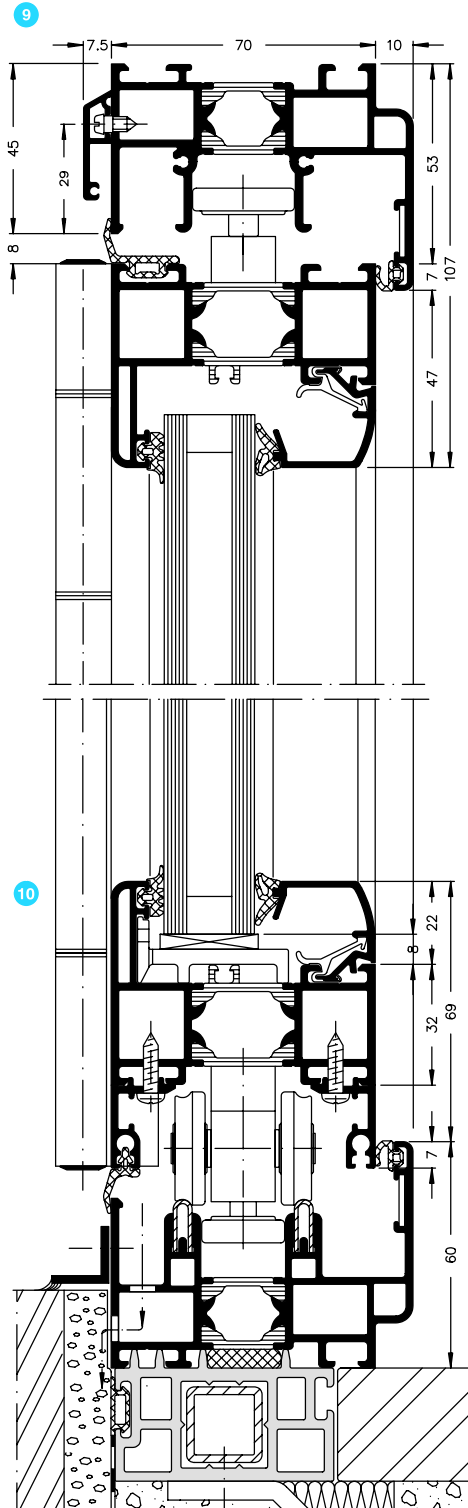
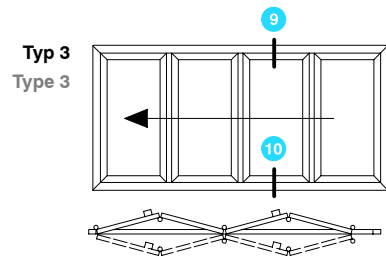

Maßstab 1:2
Scale 1:2

Oberer und unterer Türabschluss
nach innen öffnend
Ausführung als Balkonverglasung
Top and bottom door sills
inward opening
balcony glazing design

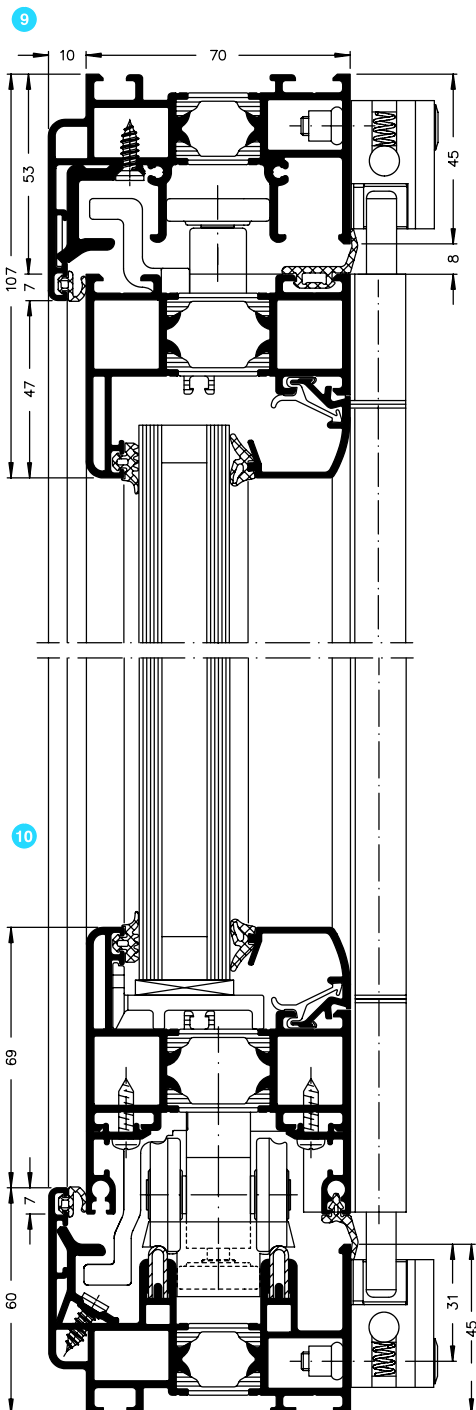

Typ 3
Type 3

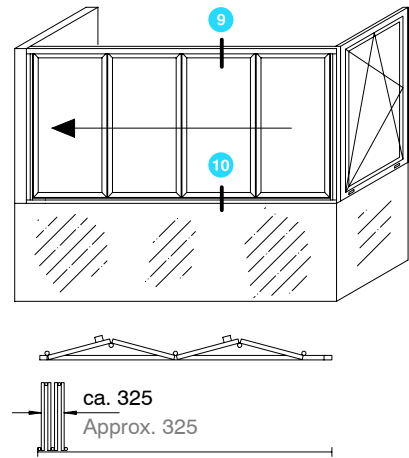

Maßstab 1:2
Scale 1:2

Faltschiebetüren
 Ausführung als Balkonverglasung
 Folding sliding doors
 balcony glazing design

Typ 3
 Type 3

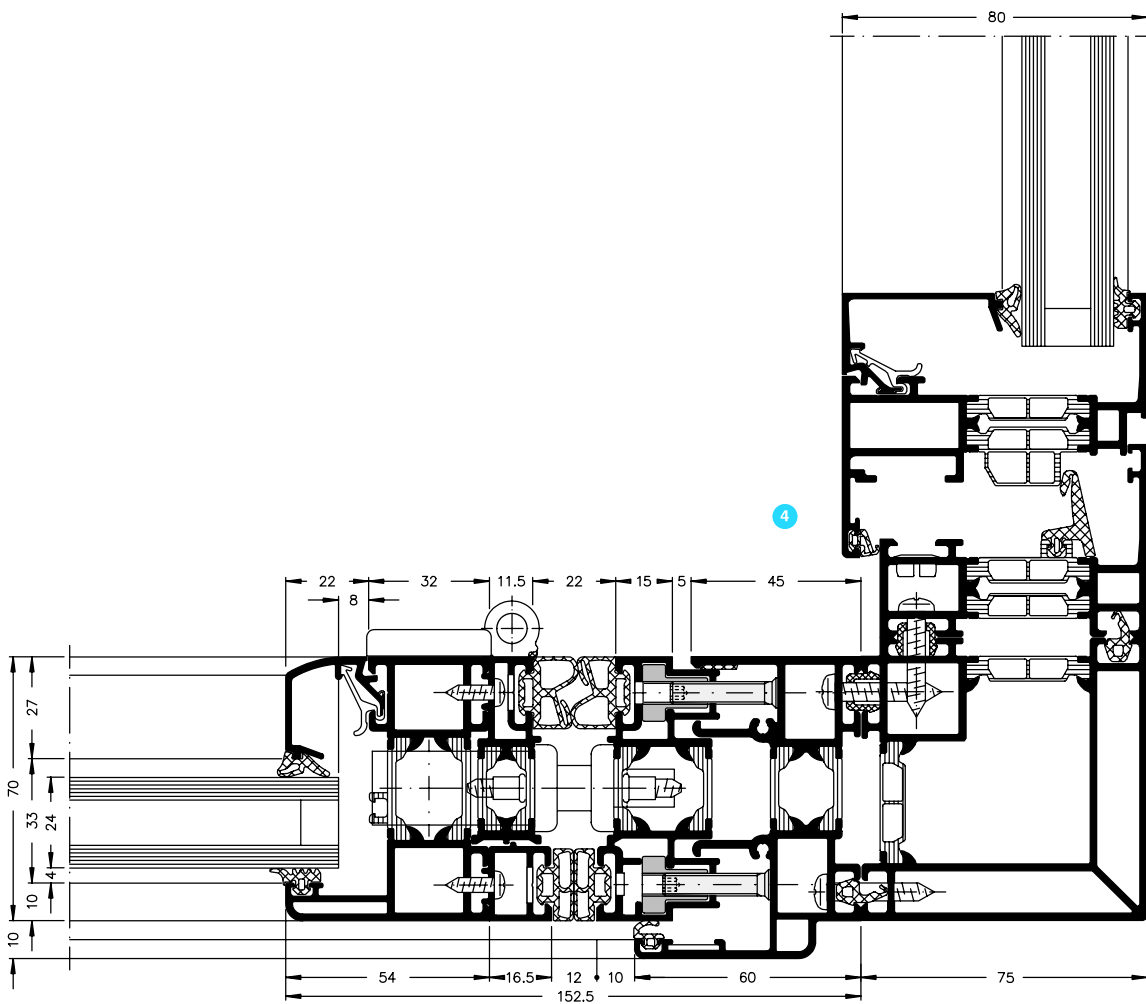
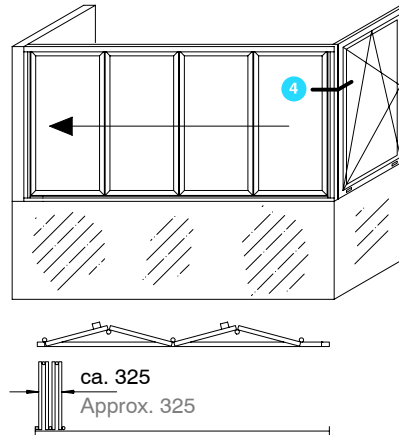

Maßstab 1:2
 Scale 1:2